

W2604**LIGHTING MCQUEEN Super 6
6 VOLT ADVANCED SERIES**

Age Range: 3-7 Years
 Weight Limit: 65 lbs.
 Surfaces: Hard and Grass
 Speed: 3.5 MPH Forward/Reverse

Colors: Red Body, Black Wheels
 Intro: 2011
 Suggested Retail: \$249.99
 Box Dimensions: 26x17x51
 Warranty: One Year Vehicle
 Six Months Battery

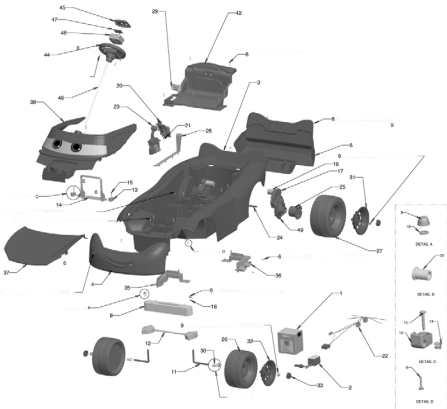

**POWER
WHEELS**
by Fisher-Price®

Item	Part Number	Description	QTY	Item	Part Number	Description	QTY
1	00801-0712	S6V BATTERY	1	42	N/A	SEAT	1
2	00801-1779	S6V CHARGER FUSED	1	44	3800-1003	STEERING WHEEL	1
3	N/A	BODY	1	45	H8256-2379	STEERING WHEEL COVER	1
4	3800-8089	FRONT BUMP	1	46	W2603-9759	SOUNDBOX ASSEMBLY	1
5	N/A	REAR BUMPER	1	47	N/A	ASSY. BATTERY DOOR	1
6	0912-8001	#8 X 3/4 PH PLAS SCREW	28	48	H8256-4239	STEERING COLUMN	1
8	N/A	MODULE, FRONT	1	49	00968-2924	GEARBOX ASSEMBLY	1
9	0801-0226	.437 RETAINER - PALNUT	6	50	3900-1002	REAR SPOILER	1
11	H8256-4509	FRONT AXLE	2	PARTS NOT SHOWN			
12	H8256-9419	ASSY STEERING LINKAGE	1	Part Number	Description	QTY	
13	N/A	RETAINER PIVOT	2	W2604-0301	MAIN DECAL	1	
14	3800-7809	BATTERY RETAINER	1	W2604-0920A	OWNERS MANUAL	1	
15	N/A	#12 X 1.25 SCREW	2	W2604-9259	PARTS BAG	1	
16	00801-1337	1/4" FLAT WASHER	2	W2604-9289	HARDWARE BAG	1	
17	00968-2821	GEARBOX ASSY	1	78640-2629	CAP NUT TOOL	1	
18	00968-2710	MOTOR PINION ASSY	1	0801-0196	7/16 WASHER	2	
20	H8256-9389	ASSEMBLY FOOTBOARD	1	00905-0116	3/8" - 16 HEX NUT	2	
21	00801-2039	FITSWITCH-PLUNGER TYPE	1	00801-1421	.354 RETAINER-PALNUT	3	
22	N9733-9799	MAIN WIRING HARNESS	1	00801-1775	SWITCH CONTROL-SHIFTER	1	
23	H8256-9239	SHIFTER	1				
24	H8256-4519	REAR AXLE	1				
25	74460-2249	DRIVER	2				
26	H8256-2459	FRONT WHEEL	2				
27	H8256-2469	REAR WHEEL	2				
28	N/A	WIRE COVER	1				
29	*On Seat	PW EMBLEM	1				
30	73610-2689	BUSHING .437 LONG	1				
31	W2604-2289	REAR WHEEL COVER	2				
32	W2604-2579	FRONT WHEEL COVER	2				
33	H8256-2589	HUBCAP CENTER	4				
35	H8256-2169	EXHAUST PIPE, RIGHT	1				
36	H8256-2069	EXHAUST PIPE, LEFT	1				
37	3900-1039	HOOD W/LABEL	1				
38	W2604-9409	CAB	1				

Bold and Underlined parts are to be purchased and installed by Service Centers only. These may not be sold directly to consumers by Service Centers or Fisher-Price.