

Age Range: 3-6 Yrs.
 Weight Limit: 65 Lbs.
 Surfaces: Hard, Grass & Hills
 Speed: 3.5 MPH Forward & Reverse
 Colors: White Body
 Pink Wheels
 Purple Trim

Intro: 3-22-00
 Suggested Retail: \$159.99
 Box Dimensions: 40" x 19" x 25"
 51 Lbs. Ship Weight
 Warranty: One Year Vehicle
 6 Months Battery

78476-9993 Barbie Trail Rider TRU

Preschool Series Super 6 Volt

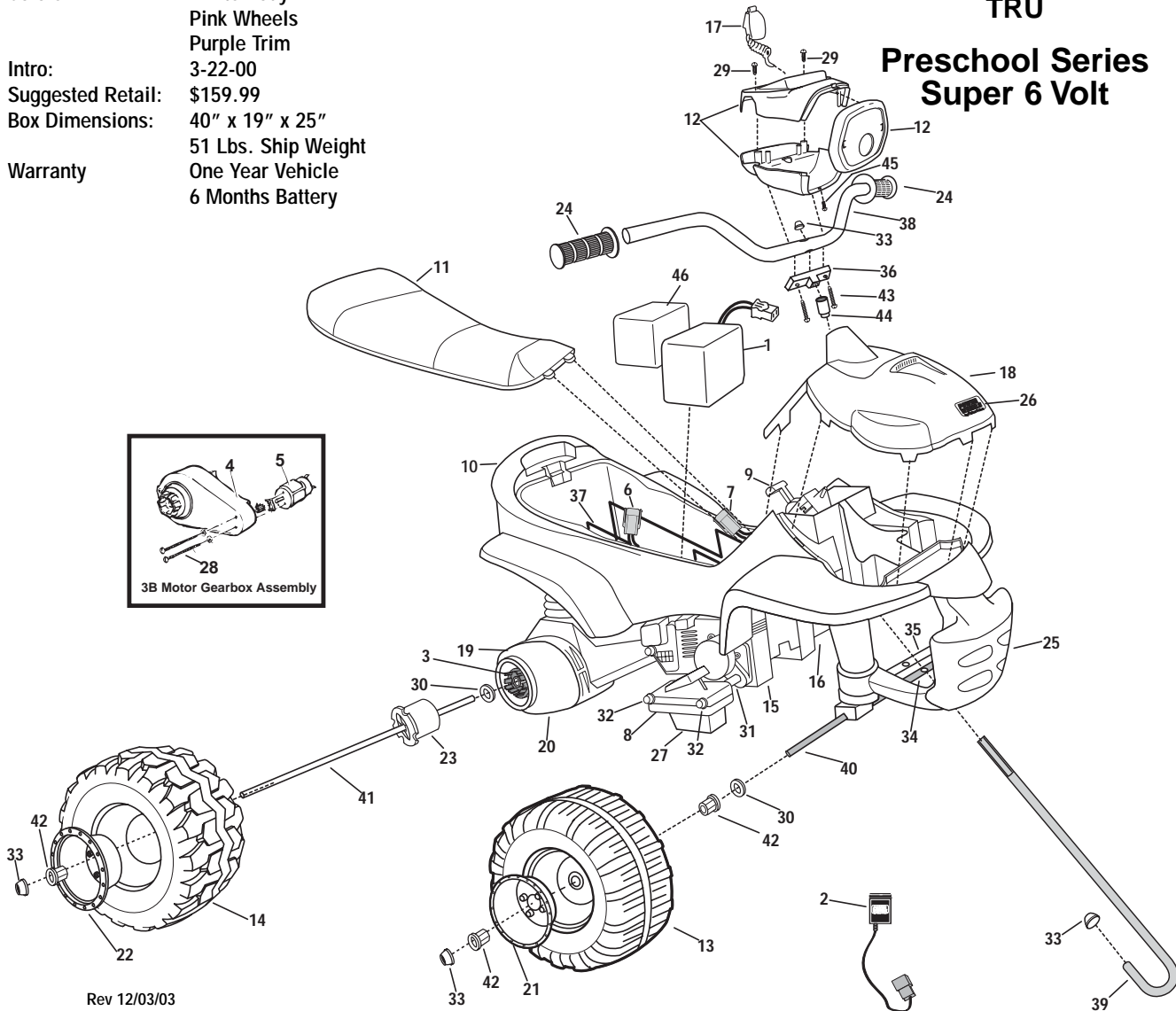

Rev 12/03/03

| Item No. | Description | Part No. | Qty. | Item No. | Description | Part No. | Qty. | Item No. | Description | Part No. | Qty. | | | |
|-----------------------------------|----------------------------------|-------------------|----------|-------------------------------|--------------------------|------------|------|------------------------|----------------------------------|------------|------|-----------------------|------------------|----------|
| Working / Electrical Parts | | | | | | | | | | | | | | |
| 1 | S6 VBattery | 00801-0712 | 1 | 20 | Motor Housing Bottom N/A | 74558-2159 | 1 | 40 | Front Axle .437 dia | 74110-4509 | 1 | | | |
| 2 | S6 Volt Charger | 00801-0974 | 1 | 21 | Hubcap / Front | 73233-2579 | 2 | 41 | Rear Axle 437 dia | 74110-4549 | 1 | | | |
| 3 | 3B Motor Gearbox Assembly | 74180-9519 | 2 | 22 | Hubcap / Rear | 74590-2579 | 2 | 42 | Hex Bushing | 73233-2559 | 6 | | | |
| 4 | Gearbox w/out Motor | 74550-9279 | 2 | 23 | Driver (10 Rib) | 74460-2249 | 2 | 43 | #8 x 2" Screw ord 78476-9269 N/A | 0801-0298 | 2 | | | |
| 5 | Motor Pinion Assembly | 74580-9539 | 2 | 24 | Handgrip Set | 74557-2219 | 1 | 44 | Steering Bushing | 78476-2259 | 1 | | | |
| 6 | Wiring Harness: Motor | 78476-9799 | 1 | 25 | Brushguard | 74558-2079 | 1 | 45 | 6 x 1/2" Screw | 0801-0222 | 1 | | | |
| 7 | Wiring Harness: Shifter | 78476-9789 | 1 | 26 | PW Emblem | 74460-9069 | 1 | 46 | Foam Spacer | 75560-0400 | 1 | | | |
| 8 | Footboard Assembly | 74527-9169 | 1 | 27 | Footboard / Lower | 74558-2179 | 1 | Parts Not Shown | | | | | | |
| 9 | Shifter Assembly | 75547-9439 | 1 | Hardware / Metal Parts | | | | 28 | Motor Bolts | 0801-0269 | 2 | Large Parts Bag N/A | 78476-9249 | 1 |
| Plastic / Other Parts | | | | | | | | | | | | | | |
| 10 | Body (N/A) | 78476-9109 | 1 | 29 | #8 x 1" Screw N/A | 0801-0224 | 2 | 29 | #8 x 1" Screw N/A | 0801-0224 | 2 | Small Parts Bag | 78476-9259 | 1 |
| 11 | Seat | B2008-2309 | 1 | 30 | 7/16" Washer | 0801-0196 | 4 | 30 | 7/16" Washer | 0801-0196 | 4 | Hardware Bag | 78476-9269 | 1 |
| 12 | Headlight Assembly | 78475-9329 | 1 | 31 | Footboard Support | 76262-4439 | 2 | 31 | Footboard Support | 76262-4439 | 2 | Literature Bag | 78476-9019 | 1 |
| 13 | Wheel / Front | 78475-2459 | 2 | 32 | .354 Cap Nut (white) | 0801-0548 | 4 | 32 | .354 Cap Nut (white) | 0801-0548 | 4 | Owner's Manual N/A | 78476-0920 | 1 |
| 14 | Wheel / Rear | 74558-2469 | 2 | 33 | .437 Cap Nut - (white) | 0801-0227 | 6 | 33 | .437 Cap Nut - (white) | 0801-0227 | 6 | Decal Sheet | 78476-0310 | 1 |
| 15 | False Motor Cover / Right N/A | 74558-2059 | 1 | 34 | Steering Linkage Assm. | 74110-9239 | 1 | 34 | Steering Linkage Assm. | 74110-9239 | 1 | Clip Adhesive | 0801-0313 | 1 |
| 16 | False Motor Cover / Left | 74558-2069 | 1 | 35 | Crossbar | 73690-4639 | 1 | 35 | Crossbar | 73690-4639 | 1 | Cap Nut Assembly Tool | 78640-2629 | 1 |
| 17 | Microphone | 74110-9479 | 1 | 36 | Powdered Metal Neck | 76816-4289 | 1 | 36 | Powdered Metal Neck | 76816-4289 | 1 | Left Footrest | 74558-2189 | 1 |
| 18 | Cowling Assembly | 74558-9099 | 1 | 37 | Battery Retainer | 74110-4429 | 1 | 37 | Battery Retainer | 74110-4429 | 1 | Footswitch | 0801-0933 | 1 |
| 19 | Motor Housing Top N/A | 74558-2149 | 1 | 38 | Handlebar | 78475-4219 | 1 | 38 | Handlebar | 78475-4219 | 1 | | | |
| | | | | 39 | Steering Column | 74110-4249 | 1 | 39 | Steering Column | 74110-4249 | 1 | | | |

N/A = Not Available

Bold and Underlined parts are to be purchased and installed by Service Centers only. These items may not be sold directly to consumers by Service Centers or Fisher-Price.

