



This product is affected by the PW recall announced Oct 1998. Please confirm that the product is modified or remediated in accordance with policy.



78475-9993 Barbie Trail Rider

Preschool Series
Super 6 Volt

TRU Exclusive

Age Range: 3-6 Yrs.
Weight Limit: 65 Lbs.
Surfaces: Hard & Grass
Speed: 3.5 MPH Fwd & Rev
Colors: White Body
Pink Wheels
Purple Trim

Intro: 8-25-98
Suggested Retail: \$159.99
Box Dimensions: 41" x 18" x 25"
Warranty: 90 Days Vehicle
6 Months Battery

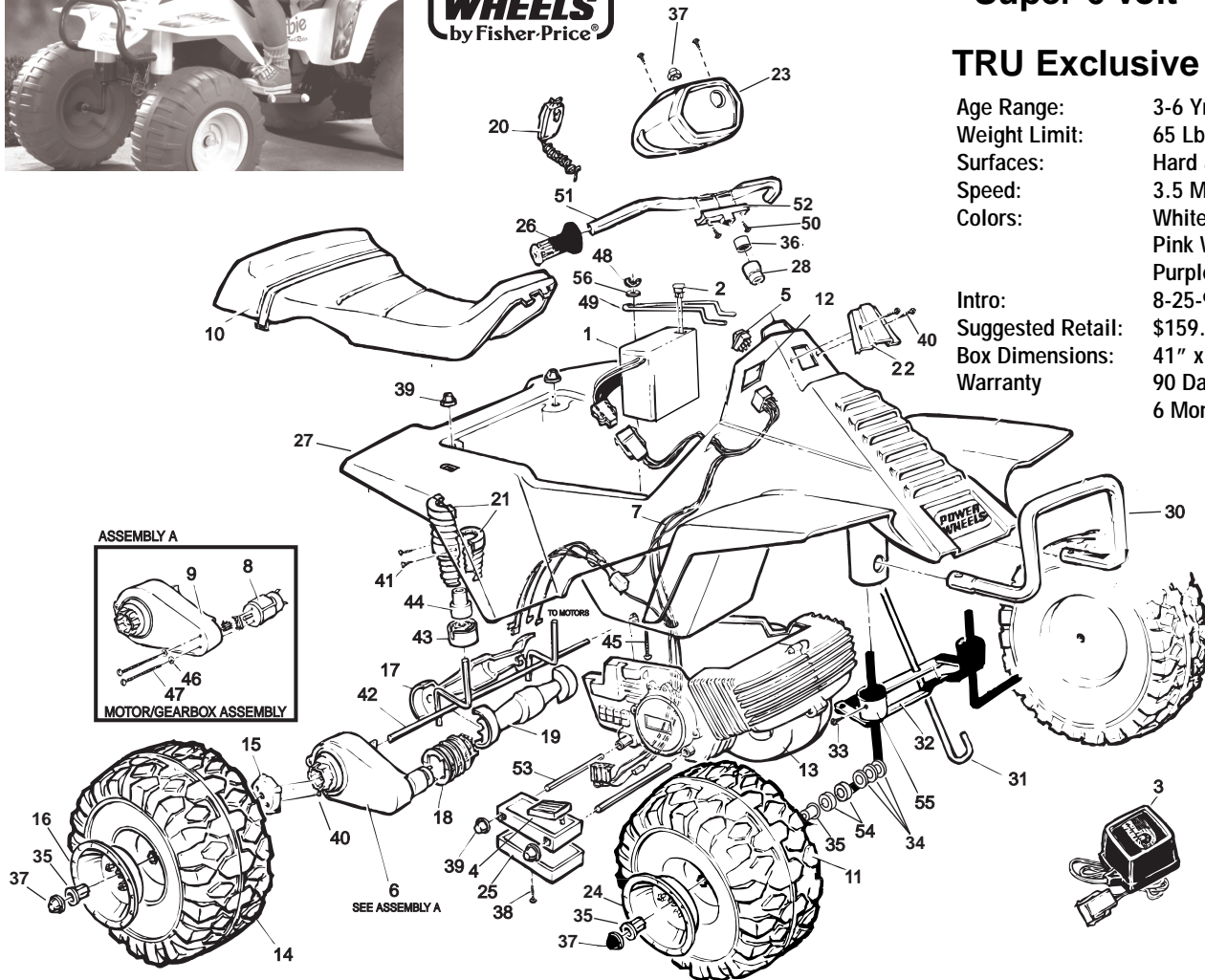

Rev. 12/10/03

Item No.	Description	Part No.	Qty.	Item No.	Description	Part No.	Qty.	Item No.	Description	Part No.	Qty.
Working / Electrical Parts											
1	Battery	00801-0712	1	21	Shock Set N/A	74557-9089	1	43	Rear Post Bushing N/A	74557-2549	2
2	Thermal Fuse N/A	0801-0610	1	22	Cover Plate N/A	74557-2169	1	44	Rear Bushing w/Extens N/A	74557-2669	2
3	Super 6 Volt Charger	00801-0974	1	23	Headlight Assembly	78475-9329	1	45	4" Carriage Bolt N/A	0801-0305	1
4	Footboard Assembly N/A	74557-9149	1	24	Front Hubcap	73233-2579	2	(Order Hardware Bag) N/A			
5	Control Switch	00801-0885	1	25	Bottom Cover / Footboard N/A	74557-2159	1	46	Star Washer N/A	0801-0330	4
6	3B Motor Gearbox Assm	74180-9519	2	26	Handgrip	74557-2219	2	47	Motor Bolts N/A	0801-0269	4
7	Main Harness N/A	75560-9719	1	27	Body (N/A)	74557-9119	1	48	Wing Nut N/A	0801-0317	1
8	Motor w/Pinion	74580-9539	2	Hardware / Metal Parts							
9	3B Gearbox w/Out Motor	74550-9279	2	28	Steering Bushing	75560-2259	1	49	Battery Retainer	0801-0686	1
Plastic Parts / Other											
10	Seat N/A	78475-2309	1	29	#8 x 1/2" Phillips Screw	0801-0202	2	50	#8 x 2" Hex Head Screw N/A	0801-0298	2
11	Front Wheel	78475-2459	2	30	Roll-Bar N/A	74557-4219	1	51	Handlebar	78475-4219	1
12	Emblem	74460-9069	2	31	Steering Column	74750-4249	1	52	Powder Metal Neck	76816-4289	1
13	False Motor N/A	74557-9059	1	32	Steering Linkage N/A	74557-9239	1	53	Footboard Support Rod	76262-4439	2
14	Rear Wheel (Pink) N/A	74557-2469	2	33	#10 x 1/2" Phillips Screw	0801-0255	2	54	Front Wheel Spacers	73233-2369	4
15	Driver	73233-2239	2	34	7/16" Washer	0801-0196	10	55	Front Post Bushing N/A	74557-2539	2
16	Rear Hubcap	74590-2579	2	35	Hex Bushing	73233-2559	6	56	#10 Washer N/A	0801-0195	1
17	Axle Cover / Outside (9") N/A	74557-2719	1	36	Spacer N/A No Sub	74570-2369	1	Parts Not Shown			
18	Motor Cover	74750-2359	2	37	.437 Cap Nut	0801-0227	5	Literature Bag N/A	78475-9019	1	
19	Axle Cover / Inside (7") N/A	74557-2739	1	38	#8 x 2" Screw N/A	0801-0268	1	Large Parts Bag N/A	78475-9349	1	
20	Microphone	74110-9479	1	39	.354 Cap Nut	0801-0548	6	Small Parts Bag N/A	78475-9259	1	
N/A = Not Available											
40 #10 x 1" Screw 0801-0220 4											
41 #6 x 1/2" Screw 0801-0222 4											
42 Rear Axle Assembly N/A 76816-4539 1											

Bold and Underlined parts are to be purchased and installed by Service Centers only. These items may not be sold directly to consumers by Service Centers or Fisher-Price.