

Age Range: 1-3 Yrs.  
 Weight Limit: 40 Lbs.  
 Surfaces: Hard & Grass  
 Speed: 1 MPH Forward  
 Colors: Black Body & Wheels  
 Green Seat

Intro: 1999 (Released 12-8-98)  
 Suggested Retail: \$74.99  
 Box Dimensions: 27" x 17" x 13"  
 Warranty: 90 Days Vehicle  
 6 Months Battery

# 76920-9993

## Lil Kawasaki

### TRU Exclusive

Toddler Series  
 Mini 6 Volt

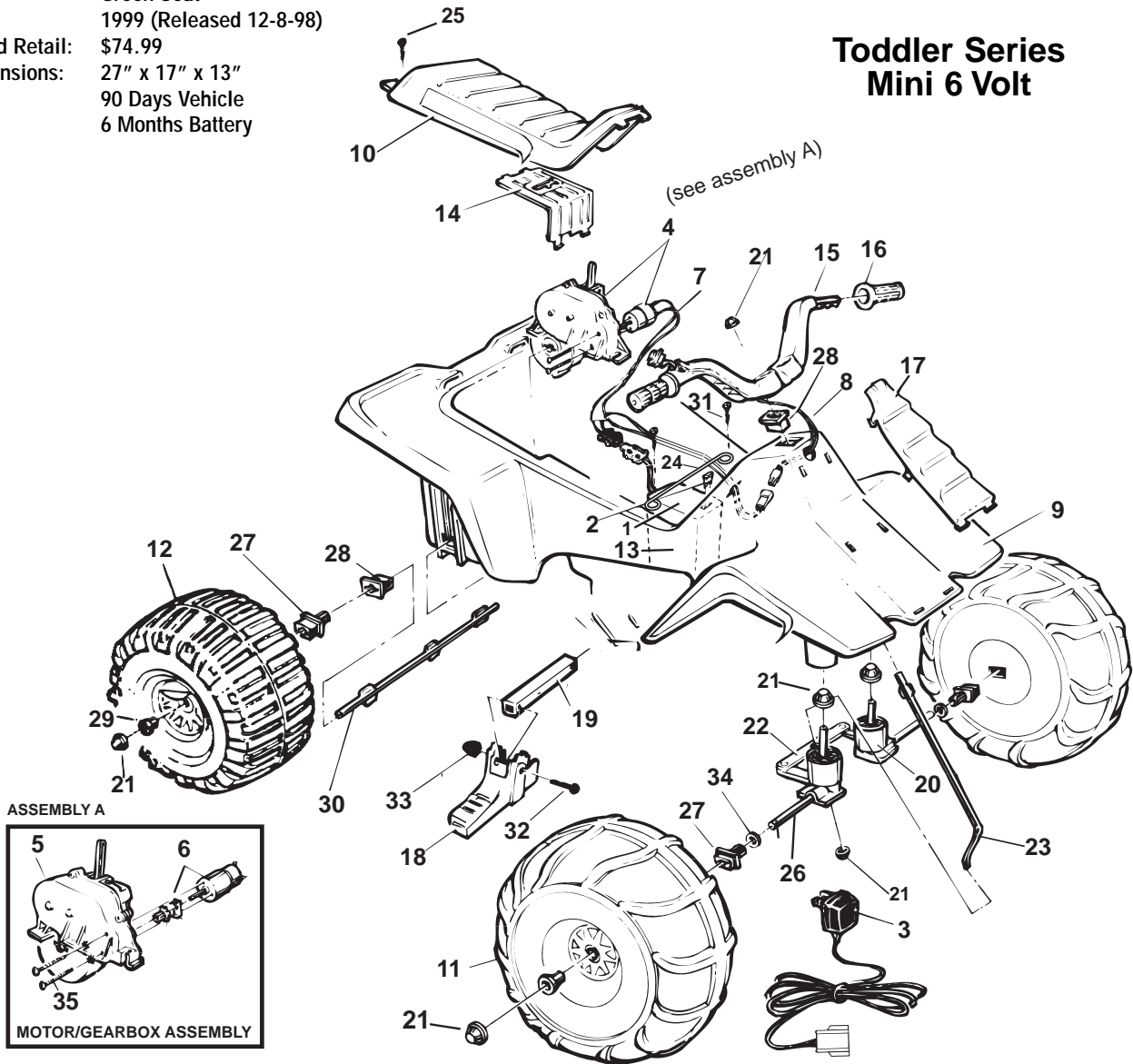

Rev. 02/04/04

Item No.	Description	Part No.	Qty.	Item No.	Description	Part No.	Qty.	Item No.	Description	Part No.	Qty.
<b>Working / Electrical Parts</b>											
1	Battery	0801-0336	1	16	Hand Grip	76920-2159	2	31	#8 x 7/8" Screw	0801-0228	2
2	25 Amp Fuse	0801-0151	1	17	Grill	76920-2149	1	32	#10 x 1-1/4" Bolt	0801-0304	2
3	Charger	00801-0976	1	18	Footpeg N/A	76920-2169	2	33	Lock (Acorn) Nut N/A	0801-0218	2
4	#5 Motor Gearbox Assembly	74504-9519	1	19	Footrest Support	76940-2179	1	34	Washer	0801-0253	2
5	#5 Gearbox W/out Motor	<u>72629-9259</u>	1	20	Front Post Bushing N/A	76920-2129	2	35	<u>Motor Bolts</u>	<u>0801-0269</u>	2
6	Motor Pinion Assembly N/A	<u>76940-9539</u>	1	<b>Hardware / Metal Parts</b>							
7	Main Harness Assembly	<u>73560-9799</u>	1	21	.354 Cap Nut (Yellow)	0801-0548	8	<b>Parts Not Shown</b>			
8	Switch Assembly	78560-9799	1	22	Steering Linkage	74504-4219	1		Large Parts Bag	76920-9249	1
<b>Plastic / Other Parts</b>				23	Steering Column	76940-4239	1		Small Parts Bag	76920-9259	1
9	Body (N/A)	76920-2209	1	24	Battery Retainer	74504-4429	1		Hardware Bag N/A	76920-9259A	1
10	Seat (Green)	76920-9319	1	25	Lock Fastener (for seat)	78570-2439	1		Literature Bag	76920-9019	1
11	Front Wheel N/A	73237-2469	2	26	Front Axle	74504-4509	2		Owner's Manual N/A	76920-0920	1
12	Rear Wheel N/A	73237-2459	2	27	Bushing w/Extension	76920-2659	2		Decal Sheet	76920-0310	1
13	Foam Battery Compartment	73560-0401	1	28	Steering Column Bushing (no Ext.)	76920-2549	3				
14	Motor Cover	73560-9489	1	29	Round (Wheel) Bushing	78560-2679	2				
15	Handlebar N/A	76920-2139	1	30	Rear Axle	74504-4539	1				

N/A = Not Available **Bold and Underlined parts are to be purchased and installed by Service Centers only. These items may not be sold directly to consumers by Service Centers or Fisher-Price.**

