

This product is affected by the PW recall announced Oct 1998. Please confirm that the product is modified or remediated in accordance with policy.

Age Range: 3-7 Yrs.
 Weight Limit: 65 Lbs.
 Surfaces: Hard & Grass
 Speed: 3.5 MPH
 Colors: White Body
 Blue & Green Trim
 Black Wheels
 Intro: 7-17-95 to 1996
 Re-Intro: 2nd Half 1997 - 1997
 Suggested Retail: \$149.99
 Warranty: 90 Days Vehicle
 6 Months Battery

75560-9993 KAWASAKI GPZ 450

Preschool Series
Super 6 Volt

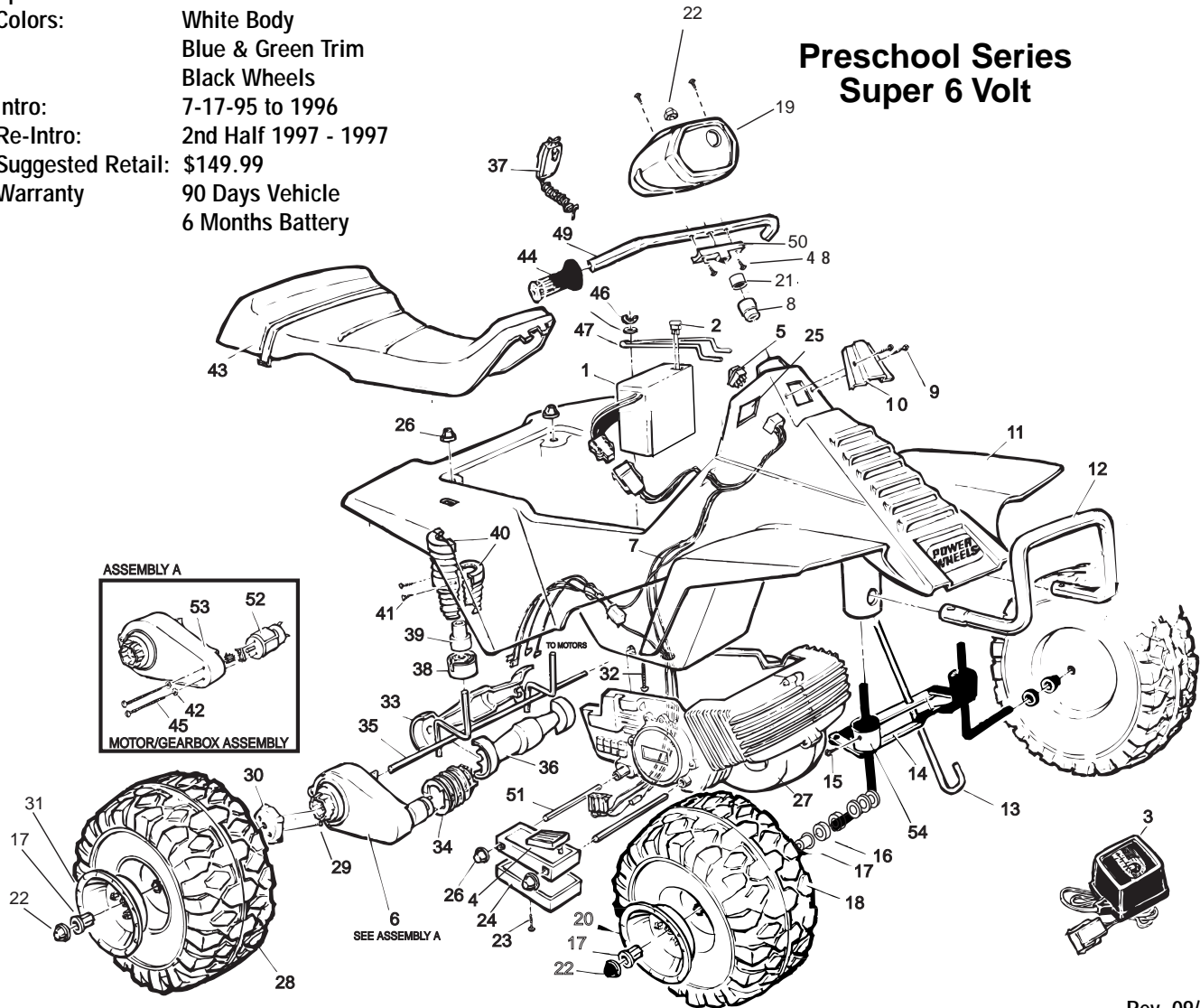

Rev. 09/11/03

Item No.	Description	Part No.	Qty.	Item No.	Description	Part No.	Qty.	Item No.	Description	Part No.	Qty.
1	Battery	00801-0712	1	23	#8 x 2" Screw N/A	0801-0268	1	44	Handgrip	78570-2219	2
2	Thermal Fuse N/A	0801-0153	1	24	Bott Cover / Footswitch N/A	74590-9159	1	45	Motor Bolts	0801-0269	4
3	Super 6 Volt Charger	00801-0974	1	25	Emblem	74460-9069	2	46	Wing Nut N/A	0801-0317	1
4	Footswitch Assembly	74590-9149	1	26	.354 Cap Nut	0801-0604	6	47	Battery Retainer	76262-4489	1
5	Control Switch	00801-0885	1	27	False Motor N/A	74590-2069	1	48	#8 x 2" Hex Head N/A	0801-0298	2
6	3B Motor Gearbox Assm	74180-9519	2	28	Rear Wheel	78570-2469	2	49	Handlebar	75560-4219	1
7	Main Harness N/A	75560-9799	1	29	#10 x 1/2" Screw	0801-0220	4	50	Powder Metal Neck	76816-4289	1
8	Step Bushing	75560-2259	1	30	Driver	73233-2239	2	51	Footboard Support Rod	76262-4439	2
9	#8 x 1/2" Phillips Screw	0801-0202	2	31	Rear Hubcap	74590-2579	2	52	Motor w/Pinion	74580-9539	2
10	Cover Plate N/A	74590-2169	1	32	Carriage Bolt N/A	0801-0305	1	53	Gearbox w/Out Motor	74550-9279	2
11	Body (N/A)	74590-2109	1		(Order Hardware Bag)	74750-2359A		PARTS NOT SHOWN			
12	Roll-Bar N/A	74590-9419	1	33	Axle Cover / Outside	74590-2579	1		Literature Bag N/A	75560-9029	1
13	Steering Column N/A	76816-4249	1	34	**Motor Cover	74750-2359	2		Large Parts Bag N/A	75560-9249	1
14	Steering Linkage N/A	74590-4239	1	35	Rear Axle Assembly N/A	76816-4539	1		Small Parts Bag N/A	75560-9269	1
15	#10 x 1/2" Phillips Screw	0801-0255	2	36	Axle Cover / Inside N/A	74590-2139	1		Decal Sheet N/A	75560-0330	1
16	7/16" Washer (3 ea side/not shown)	0801-0196	6	37	Microphone	73233-9479	1		Switch Hole Cover N/A	76188-2449	1
17	Hex Bushing	73233-2559	6	38	Rear Post Bushing N/A	74590-2549	2		Front Wheel Spacers	73233-2369	4
18	Front Wheel N/A	76266-2459	2	39	Rear Bushing w/Extens N/A	74590-2669	2				
19	Headlight Assembly N/A	75560-9339	1	40	Shock Set N/A	74590-2089	1				
20	Front Hubcap	73233-2579	2	41	#6 x 1/2" Screw	0801-0222	4				
21	Spacer N/A	74570-2369	1	42	Star Washer N/A	0801-0330	4				
22	.437 Cap Nut	0801-0226	5	43	Seat N/A	75560-2819	1				

** Sub to new 74750-2359 when motor cover 76803-2489 is depleted (effective 5-24-98)

N/A = Not Available **Bold and Underlined parts are to be purchased and installed by Service Centers only. These items may not be sold directly to consumers by Service Centers or Fisher-Price.**