

73690-9993

Ninja

On or After 1/26/04

Advanced Series 12 Volt

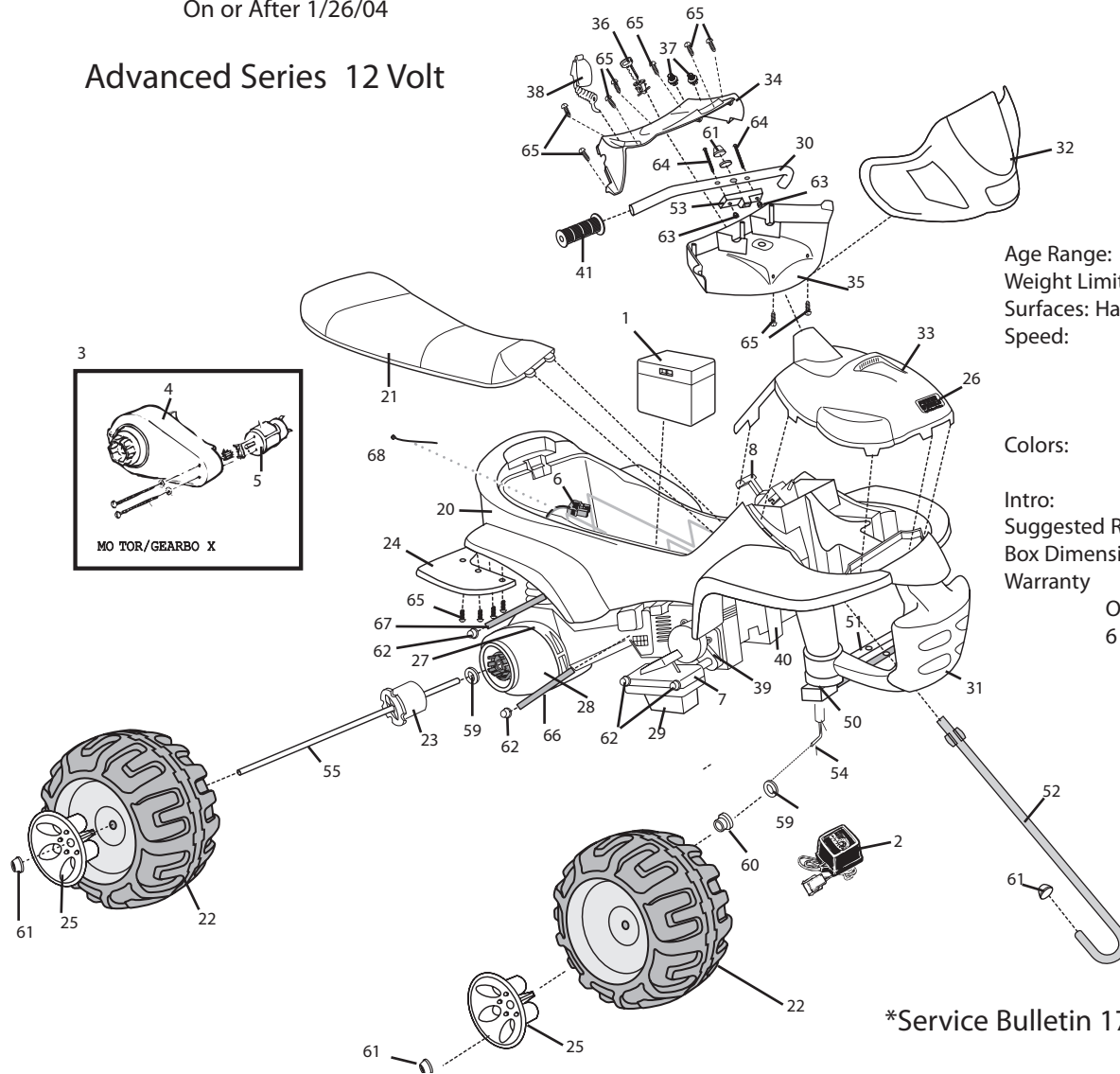

Age Range: 3 and up
 Weight Limit: 65 lbs
 Surfaces: Hard and grass
 Speed: Forward
 2.5 & 5.0 mph
 Reverse
 2.5 mph
 Colors: Blue & Yellow
 with Black tires
 Intro: 2001
 Suggested Retail: \$179.99
 Box Dimensions: 40 x 24 x 19
 Warranty: One Year Vehicle
 6 Months Battery

Rev. 02/10/06

***Service Bulletin 174**

Item No.	Description	Part No.	Qty.	Item No.	Description	Part No.	Qty.	Item No.	Description	Part No.	Qty.
Working / Electrical Parts				28	Motor Housing Bottom (After 1/26/04)	C7478-2169	1	61	*.437 Capnut Black	0801-0226	6
1	Battery 12 volt	00801-0638	1	29	Footboard lower	73690-2179	1	62	.354 Retainer Black	0801-0604	4
2	Charger 12 volt probe	00801-0972	1	30	Handle Bar	73690-4229	1	63	#10 Nylock Lock Nut N/A	0801-0318	2
3	#7 Motor Gearbox Assembly	00968-2912	2	31	Brushguard	73690-2079	1	64	#10 1 1/2 Phill Screw N/A	76222-4459	2
	(On or After 1/26/04)			32	Fairing	73690-274A	1	65	Screw #8 x 3/4" N/A	0405-2073	17
4	#7 Gearbox W/out Motor	00968-2802	2	33	Cowling Assembly	73690-9099	1	66	Motor Rod Upper N/A	74110-4559	1
	(On or After 1/26/04)			34	Dash Upper	73690-275A	1	67	Motor Rod Lower N/A No sub	74110-4569	1
5	Motor Pinion Assembly	00968-2702	2	35	Bottom Handlebar cover	73690-2769	1	68.	Harness Cable Tie	00801-1125	1
	(On or After 1/26/04)			36	Key Housing N/A	74460-9369	1	Parts Not Shown			
6	Main Harness Assembly	74110-9799	1	37	Radio Knob	74510-2149	2	Large Parts Bag (molded parts)	73690-9449	1	
7	Footboard Assembly	73690-9169	1	38	Microphone	73690-9479	1	Small Parts Bag (purchased parts)	73690-9459	1	
8	Shifter Assembly	73690-9439	1	39	False Motor Cover Right	73690-2059	1	Hardware Bag	73690-9279	1	
	*See Parts Not Shown			40	False Motor Cover Left	73690-2069	1	Owners Manual	73690-0920	1	
Plastic / Other Parts				41	Handgrip	73690-2229	2	Decal Sheet	73690-0310B	1	
20	Body	N/A		Hardware / Metal Parts				Capnut Tool	78640-2629	1	
21	Seat	73690-2309	1	50	Steering Linkage Assembly	74110-9239	1	Control Switch (rocker style)	00801-0923	1	
22	Wheel	73690-2469	4	51	Crossbar	73690-4649	1	Paper Kit N/A	73690-Paper	1	
23	Driver	74460-2249	2	52	*Steering Column	73690-4249	1	Footrest	73690-2189	1	
24	Mud Flap Set	73690-8001	1	53	Metal Neck	73690-4289	1	Hi-Speed Lock Out Screw	0801-0198	1	
25	Hubcap	73690-2579	4	54	Axle Front	73690-4509	2	*12V Shifter Harness	74110-9689	1	
26	PW Emblem	74460-9069	1	55	Axle Rear	73690-4549	1		(On or Before 10/31/03)		
27	Motor Housing Top (After 1/26/04)	C7478-2159	1	56	Upper Bushing	74110-2129	1	*12V Shifter Assembly w/Harness	73690-9679D	1	
				57	Lower Bushing	74110-2639	1		(After 10/31/03)		
				59	7/16 Washer	0801-0196	5				
				60	Round Bushing	74550-2689	2				

Bold and Underlined parts are to be purchased and installed by Service Centers only. These items may not be sold directly to consumers by Service Centers or Fisher-Price.